

Venue Smoking Shelter - L.5020 W.2170 H.2635

Side cladding + Rear cladding - Code 529374

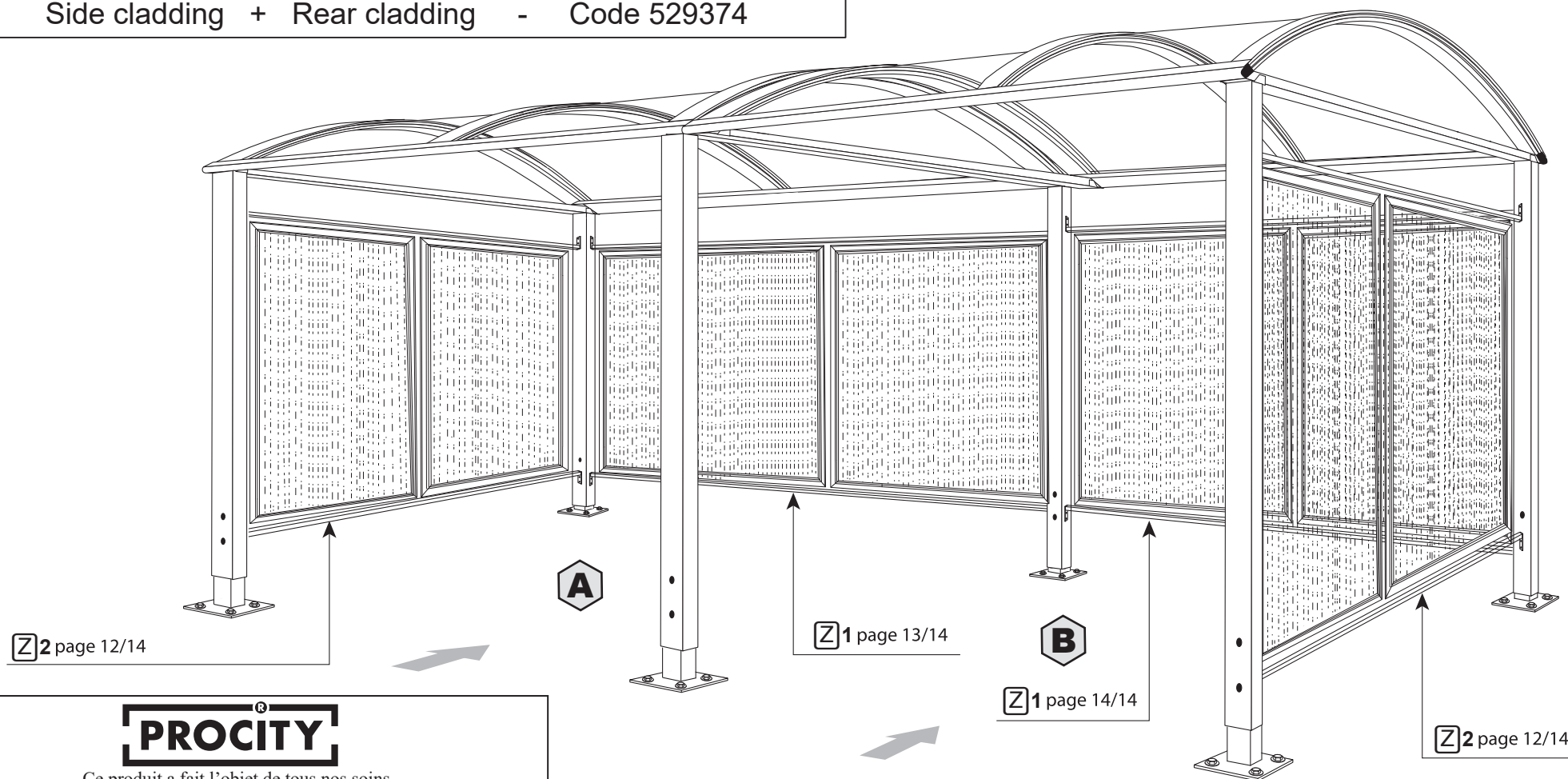

PROCITY

Ce produit a fait l'objet de tous nos soins
This product has received our best attention

Monté par / Assembled by :

.....

Emballé par / Packed by :

.....

N° OF :

.....

Pour toute demande de renseignement technique ou réclamation éventuelle, notre Service Après-Vente est à votre disposition au 02.54.80.32.99 (merci de fournir les numéros ci-contre).

For any further technical information or for any comments, please contact directly our Customer Service at 00.33.1.39.08.26.55 (Thank you to provide the opposite numbers).

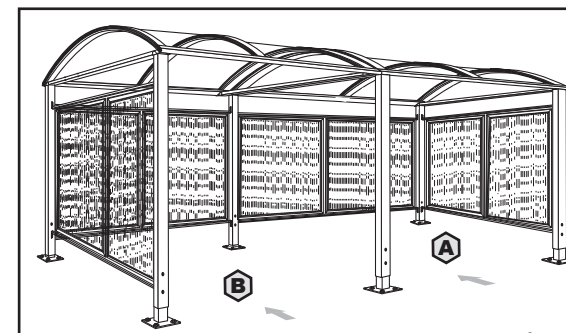
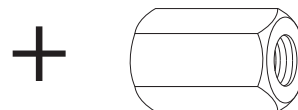

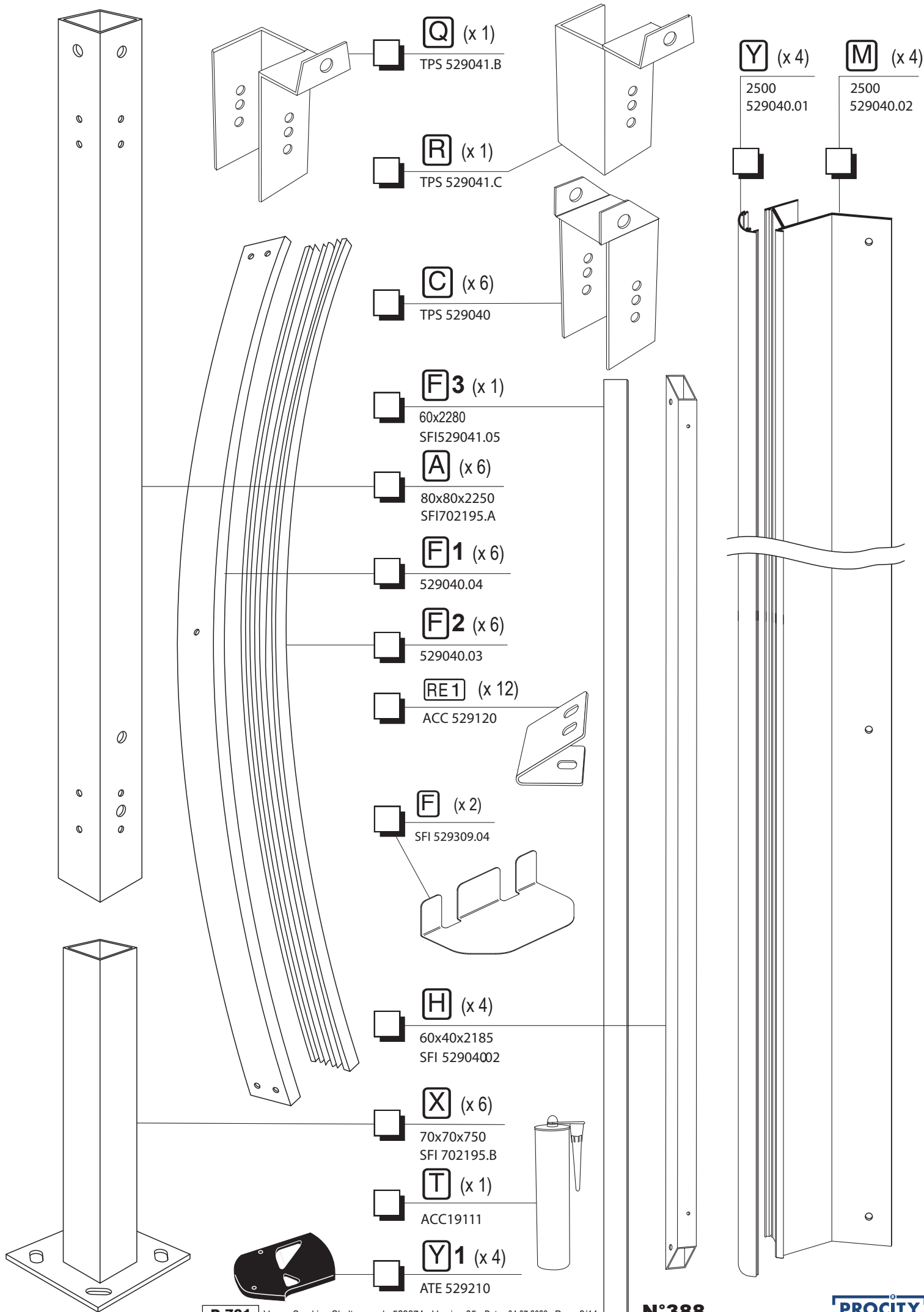

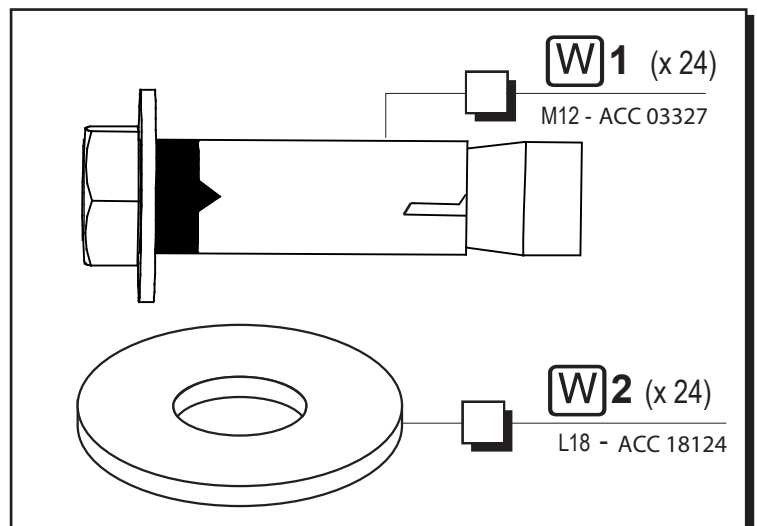
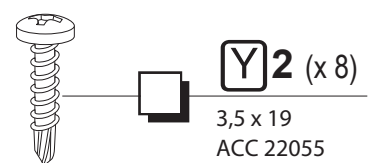
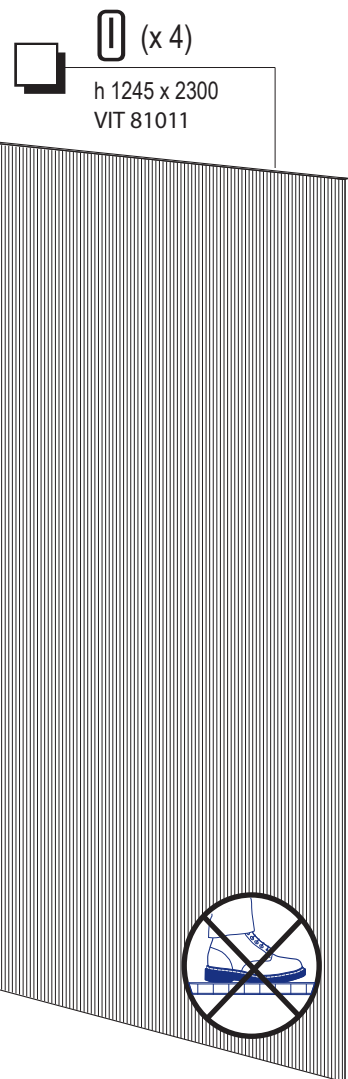
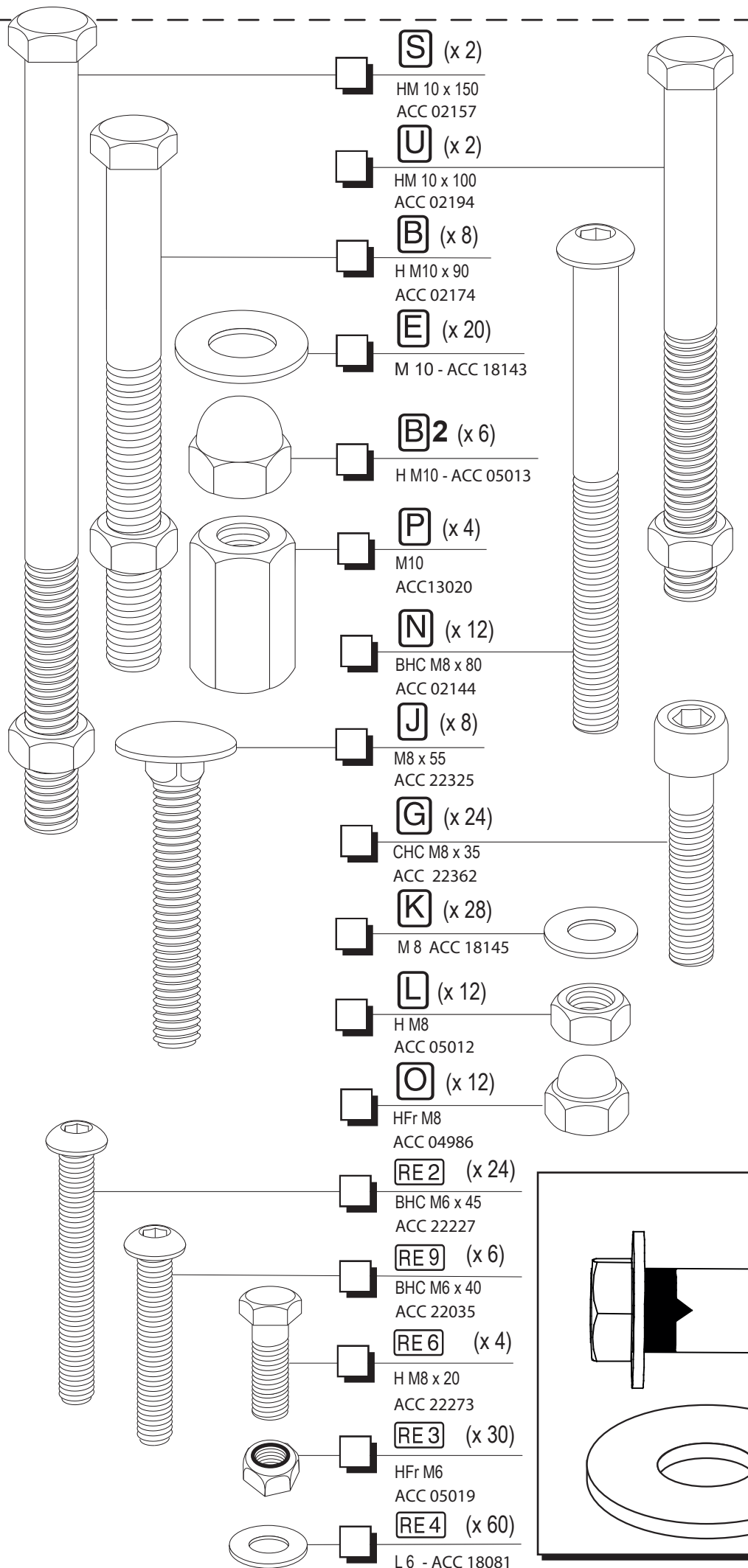

Procity = (x0)

x2

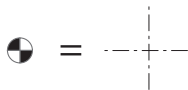
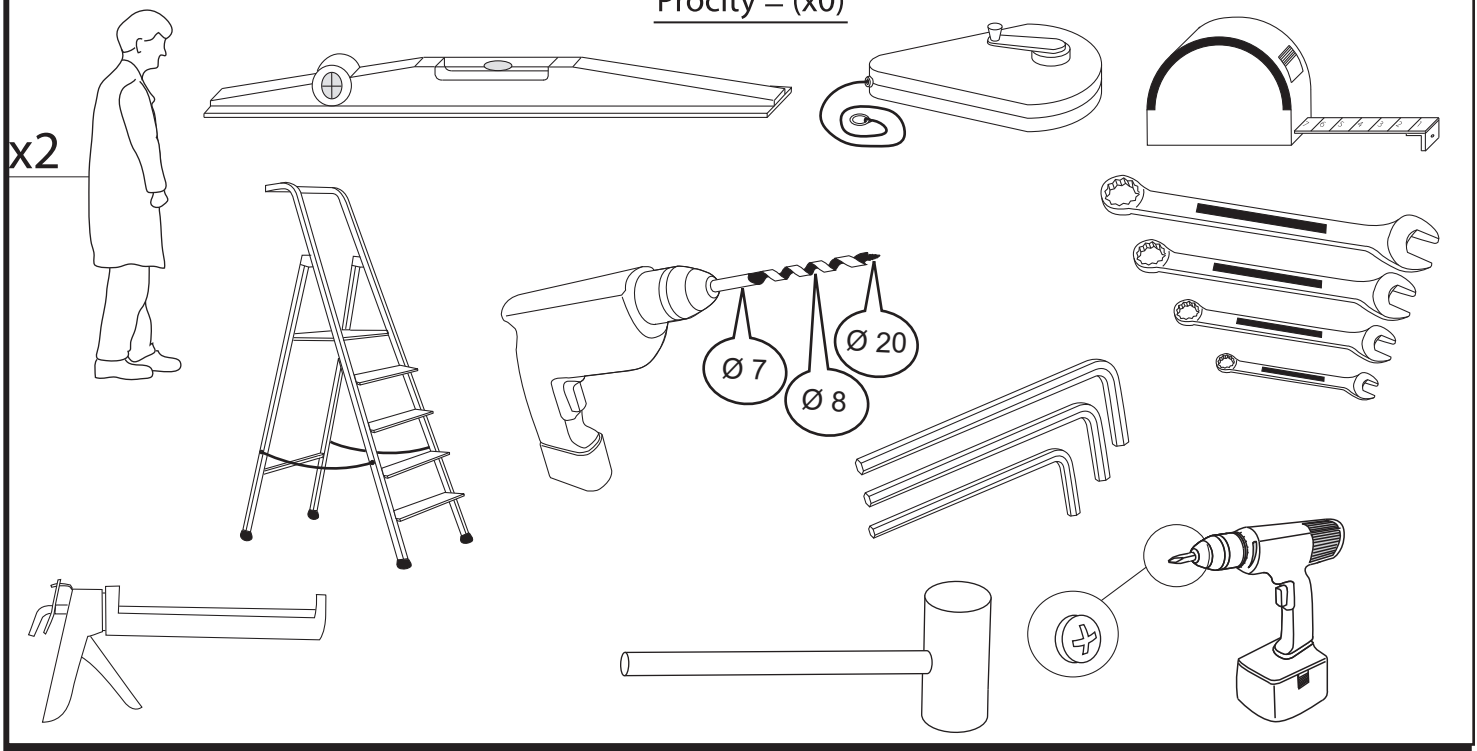

1

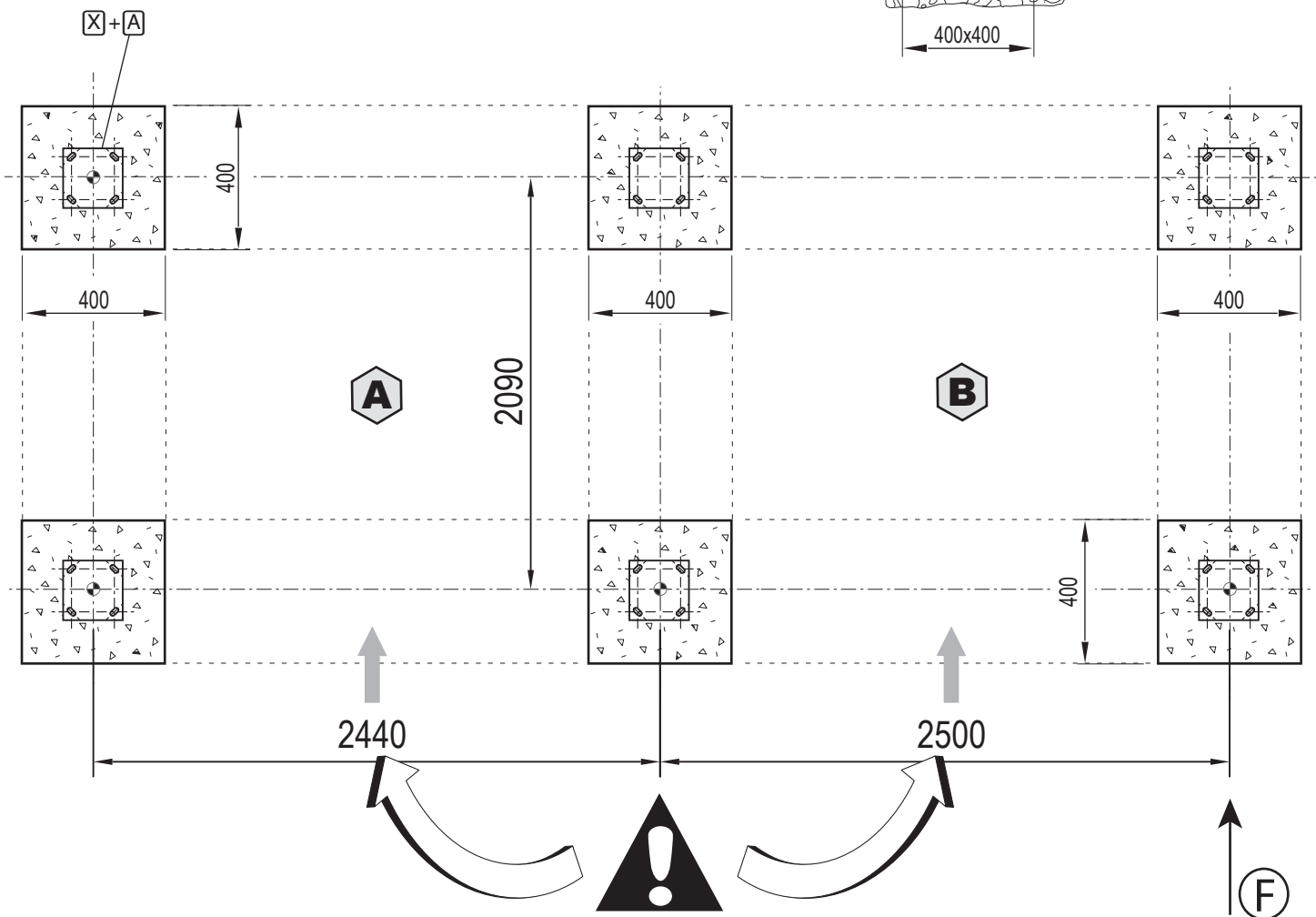
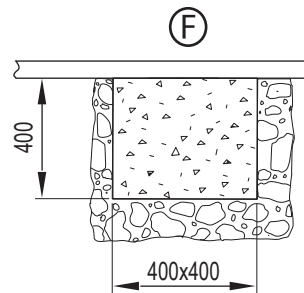

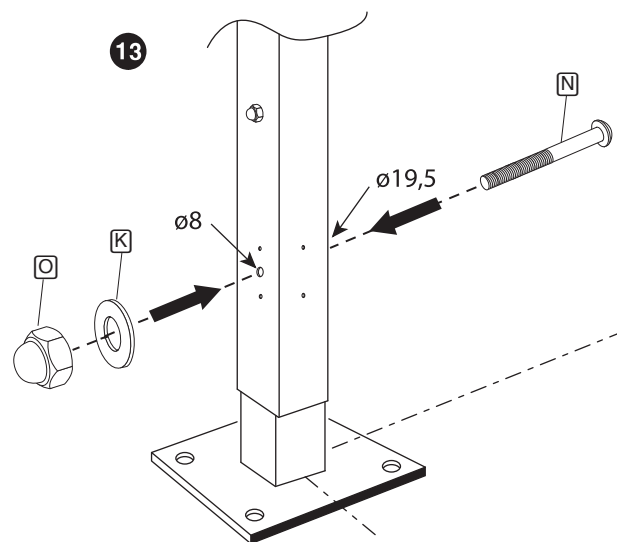
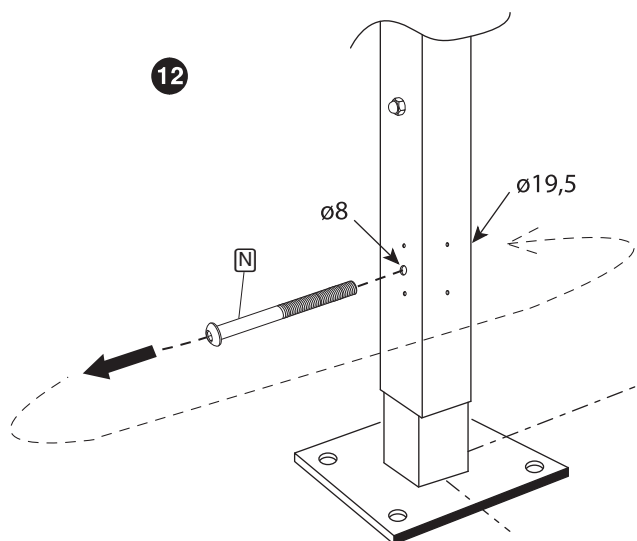
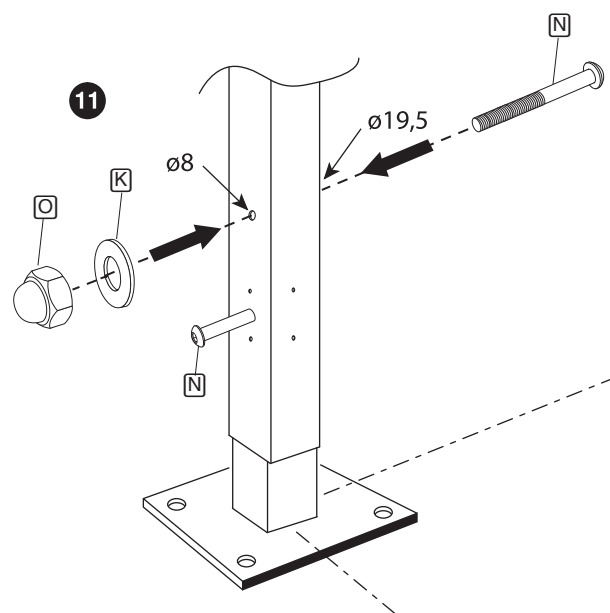
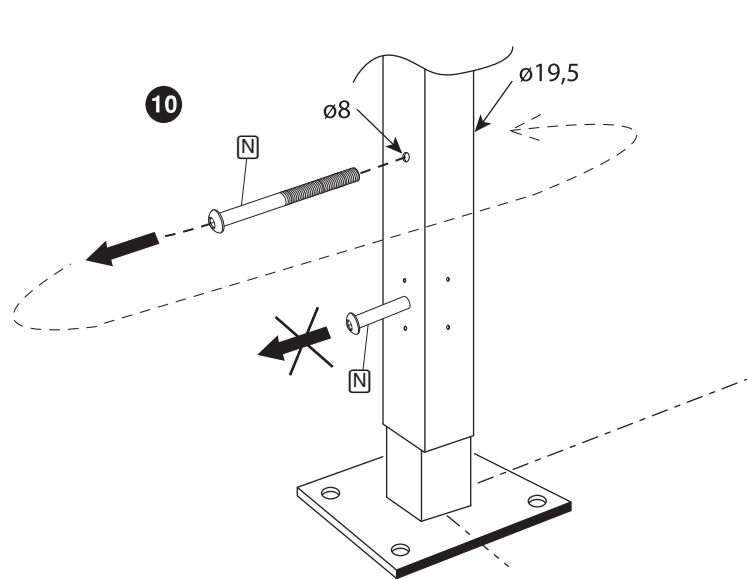
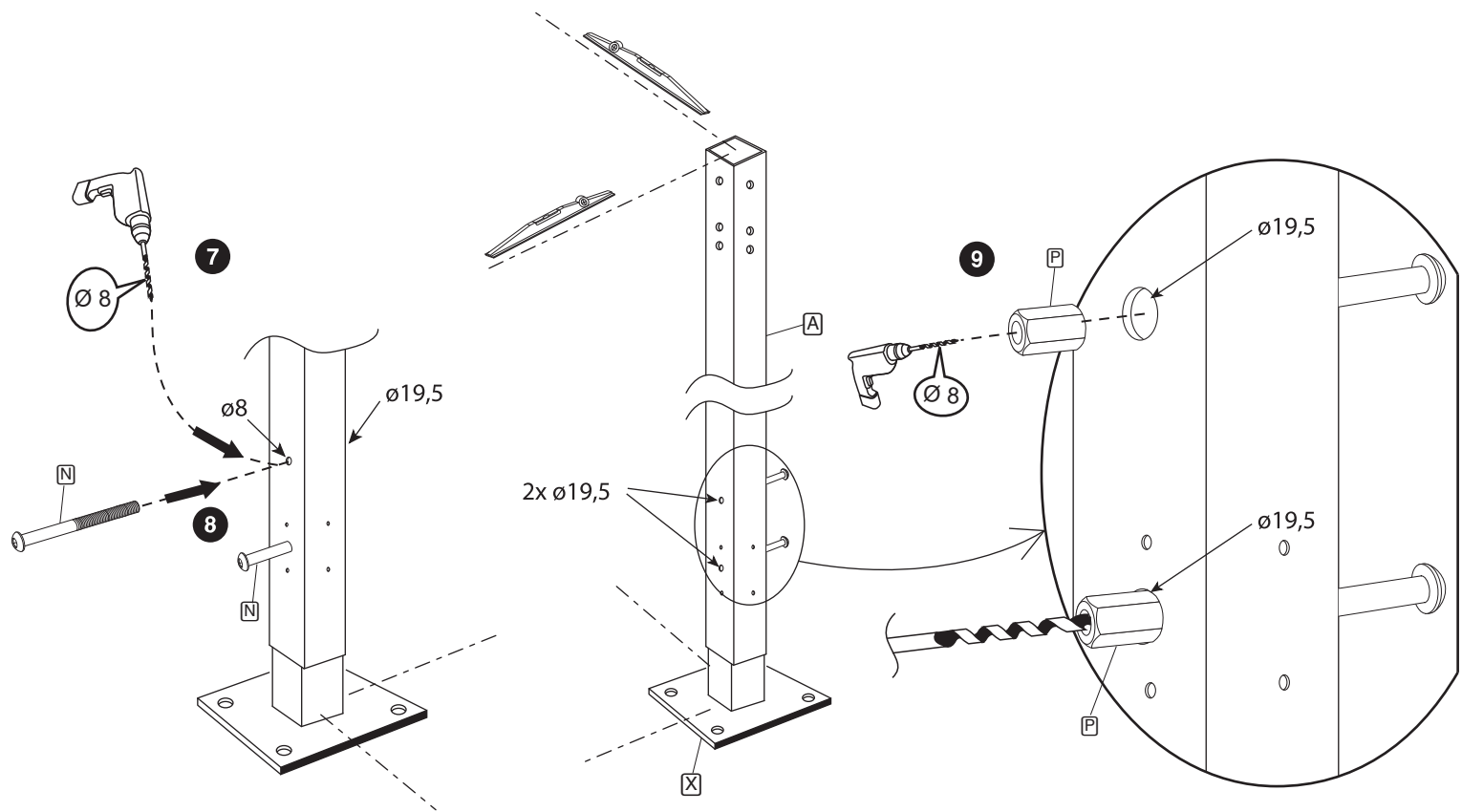

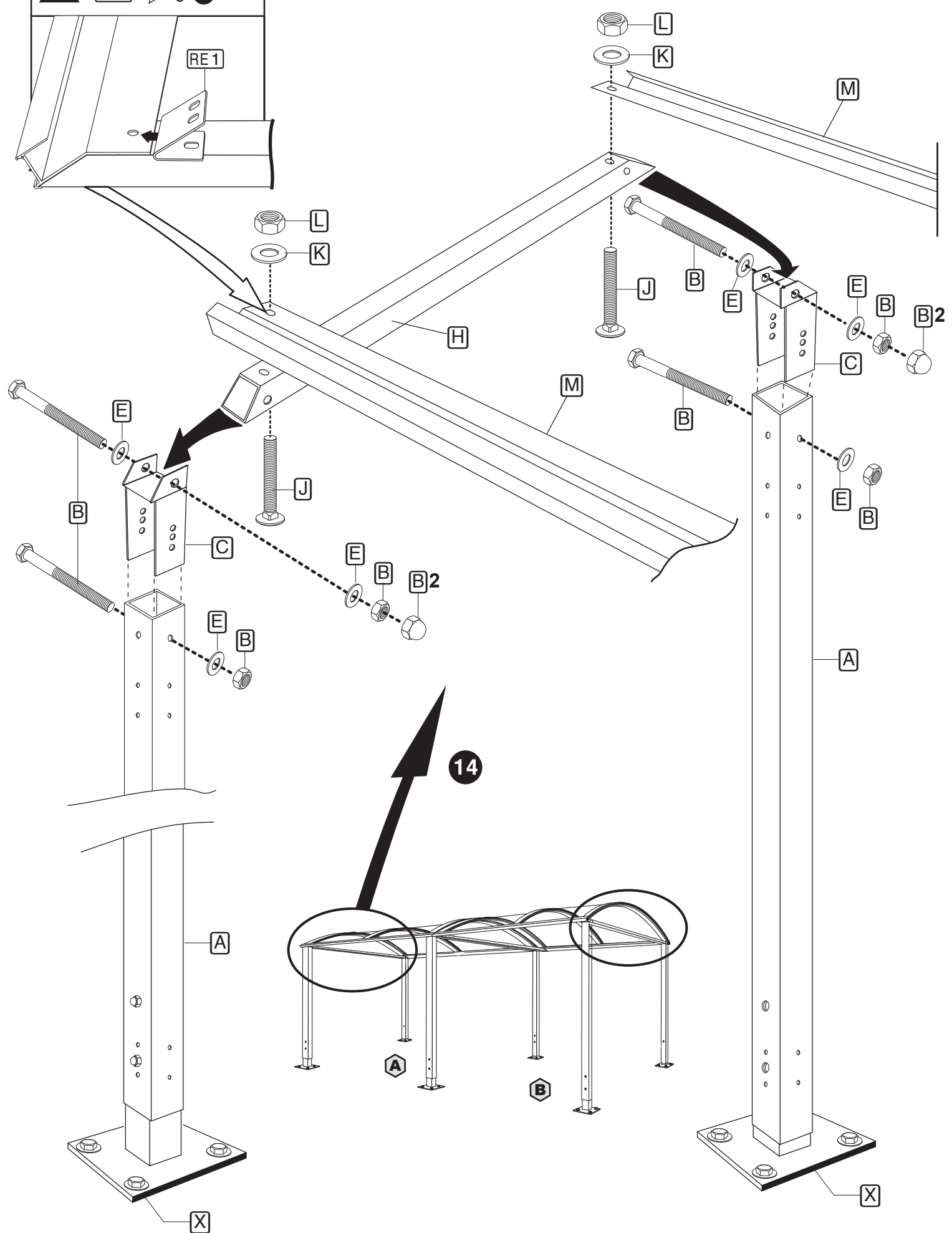
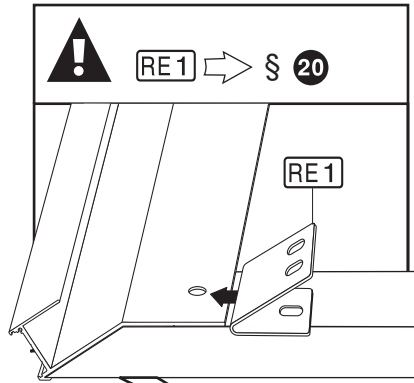

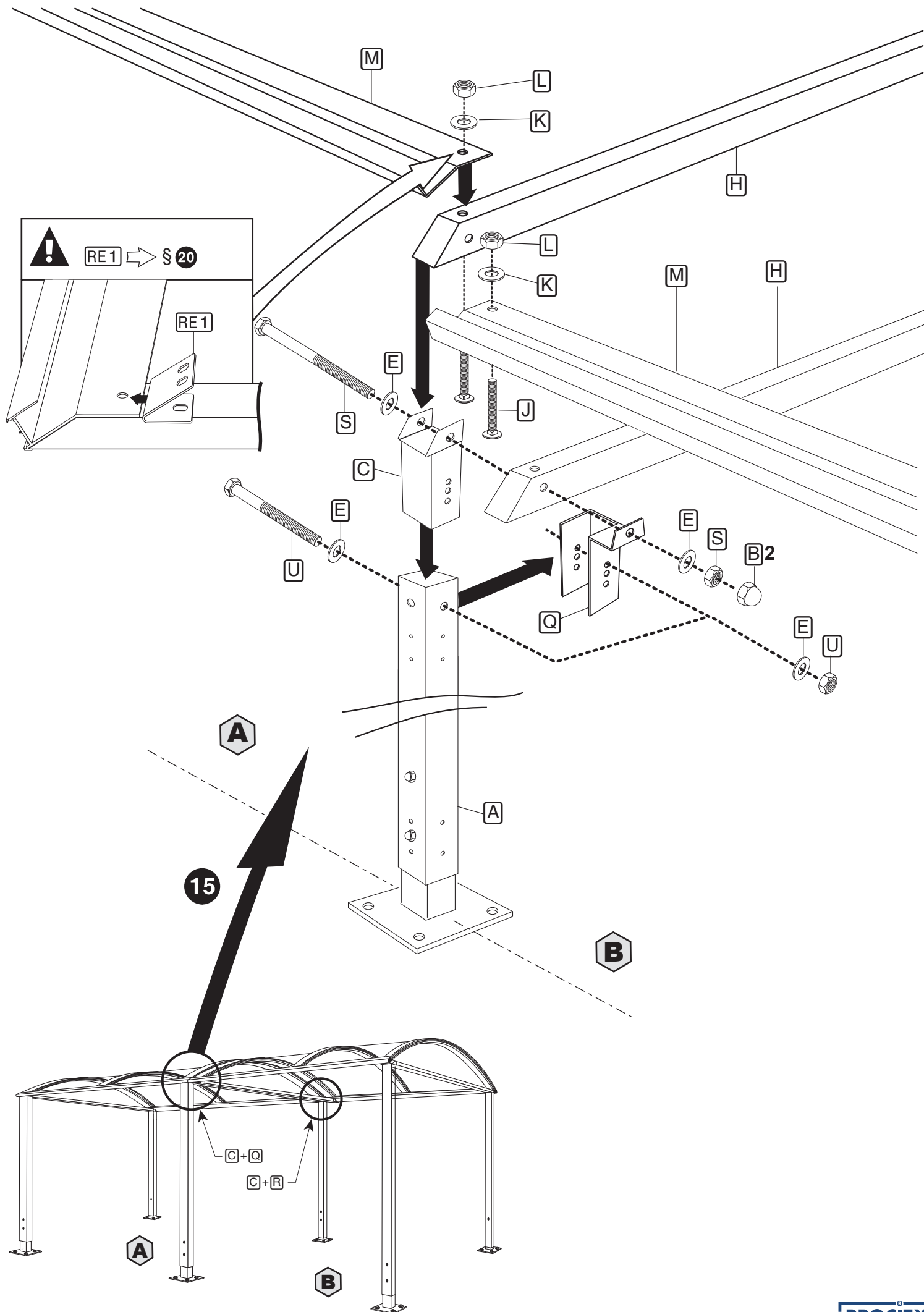

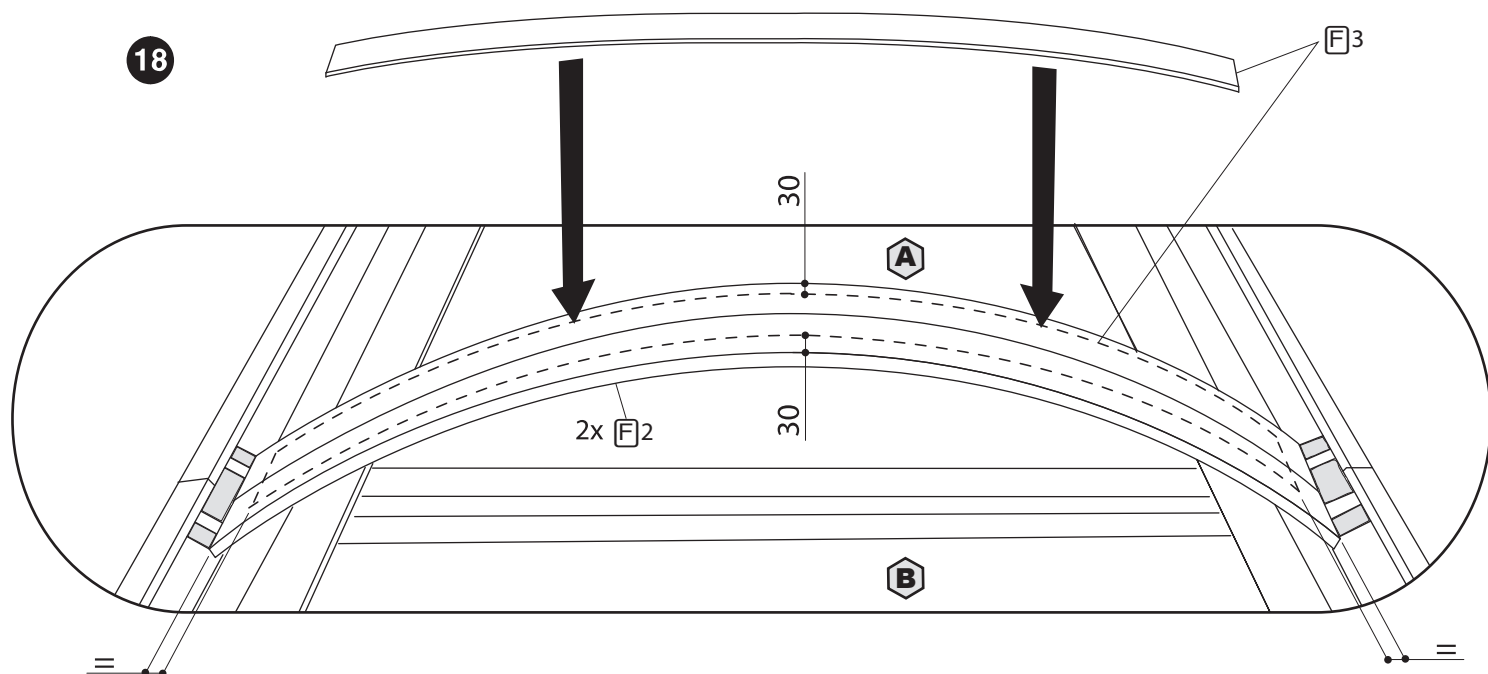
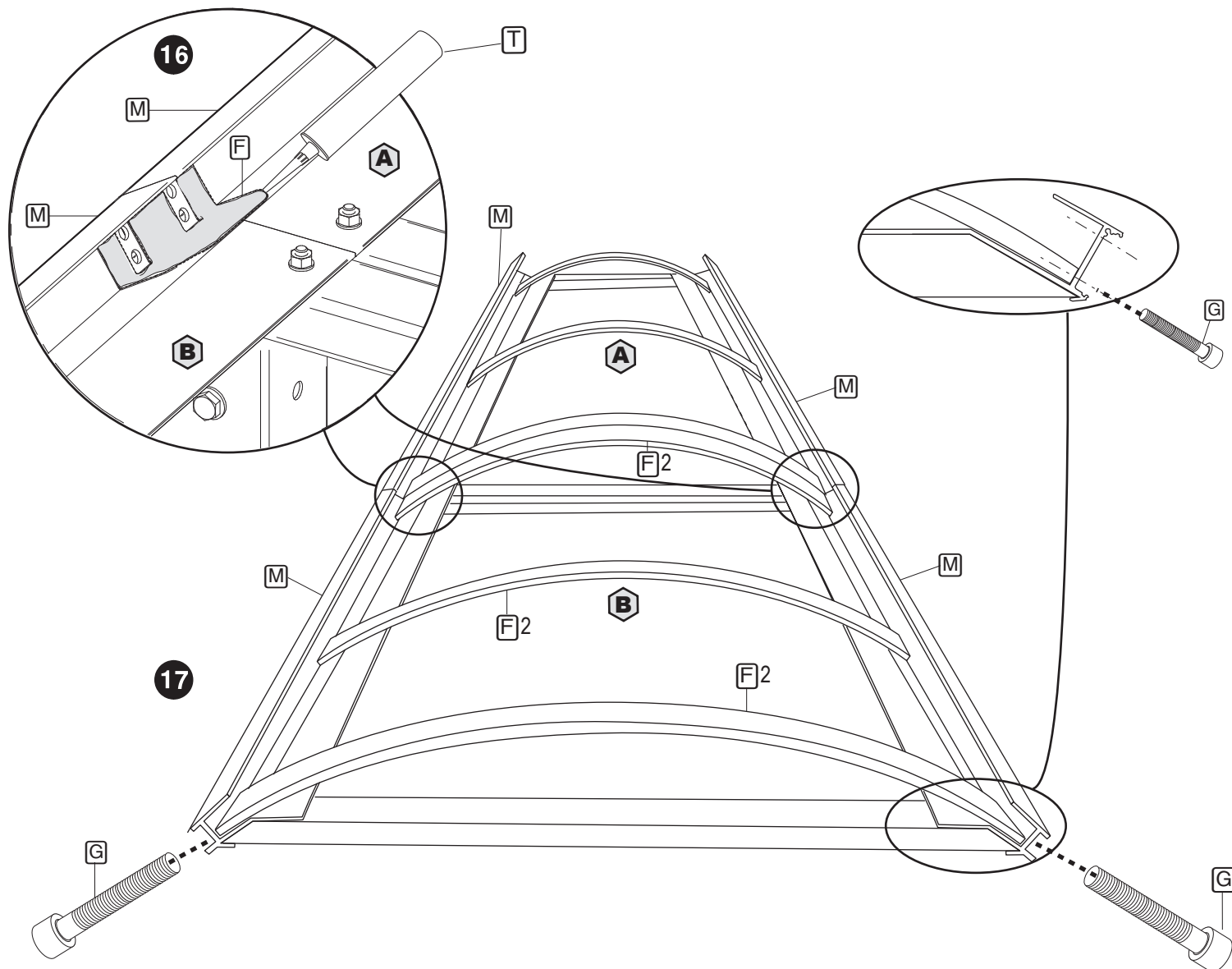

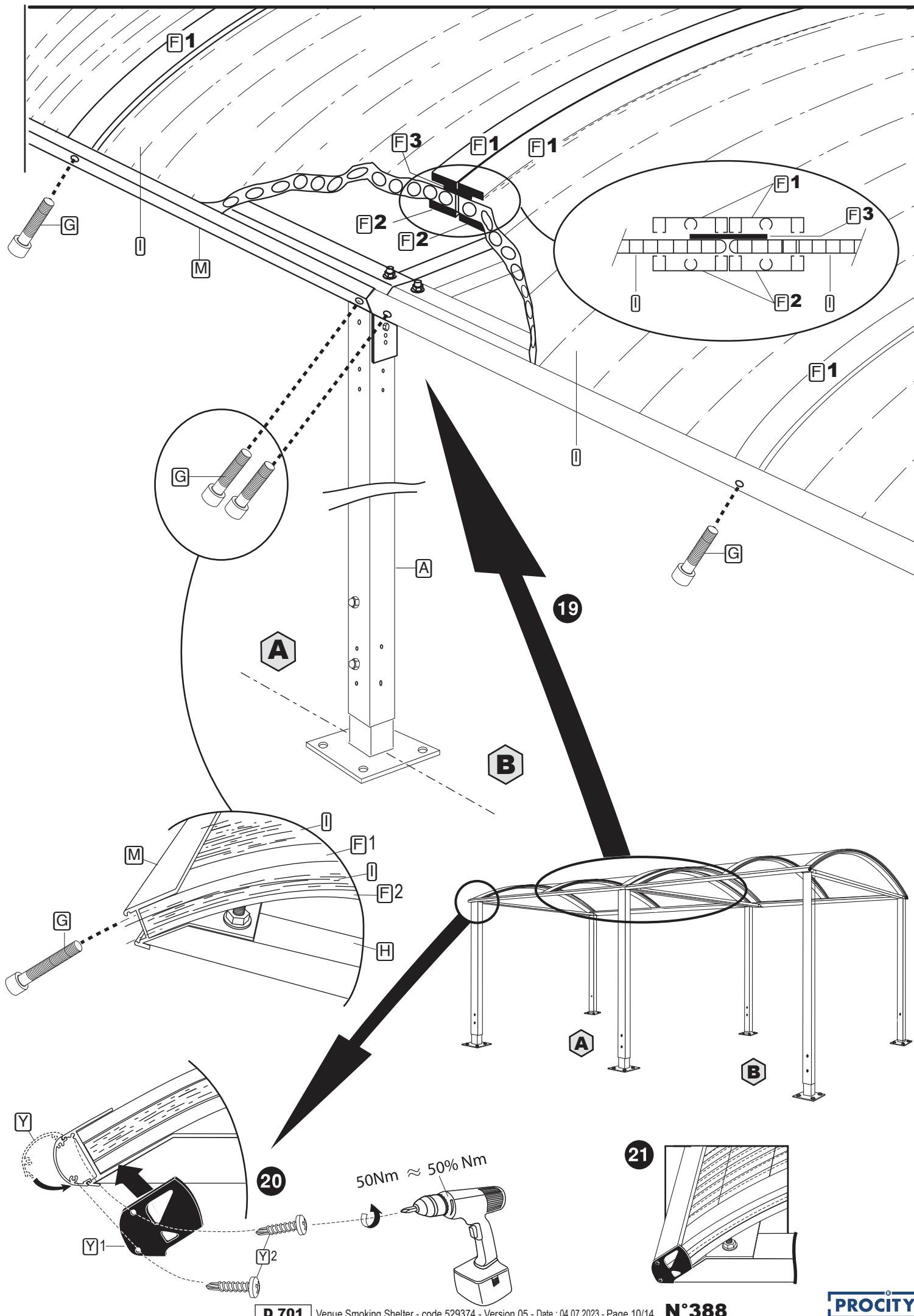

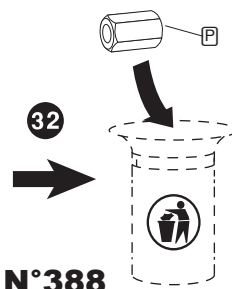
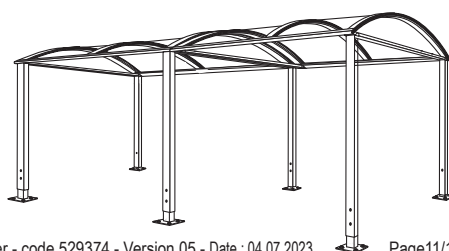
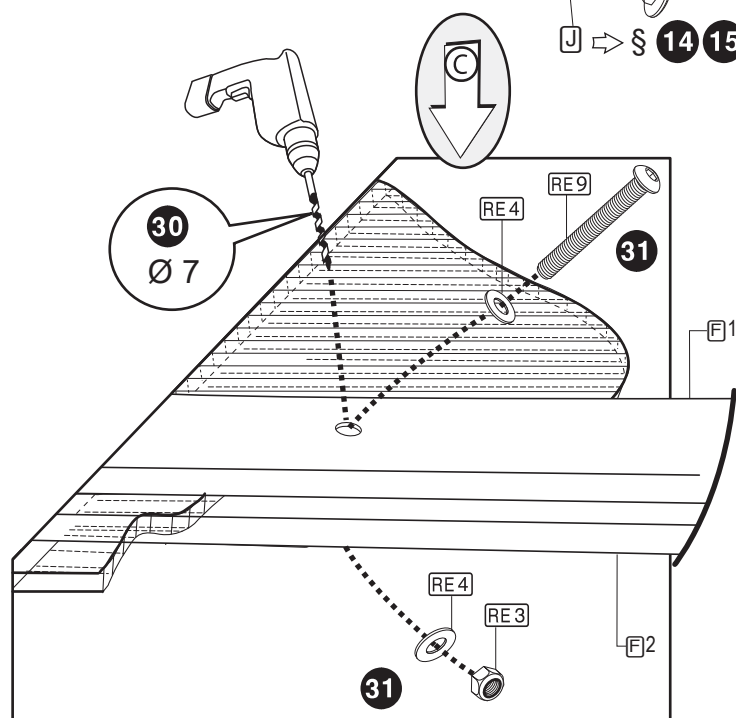
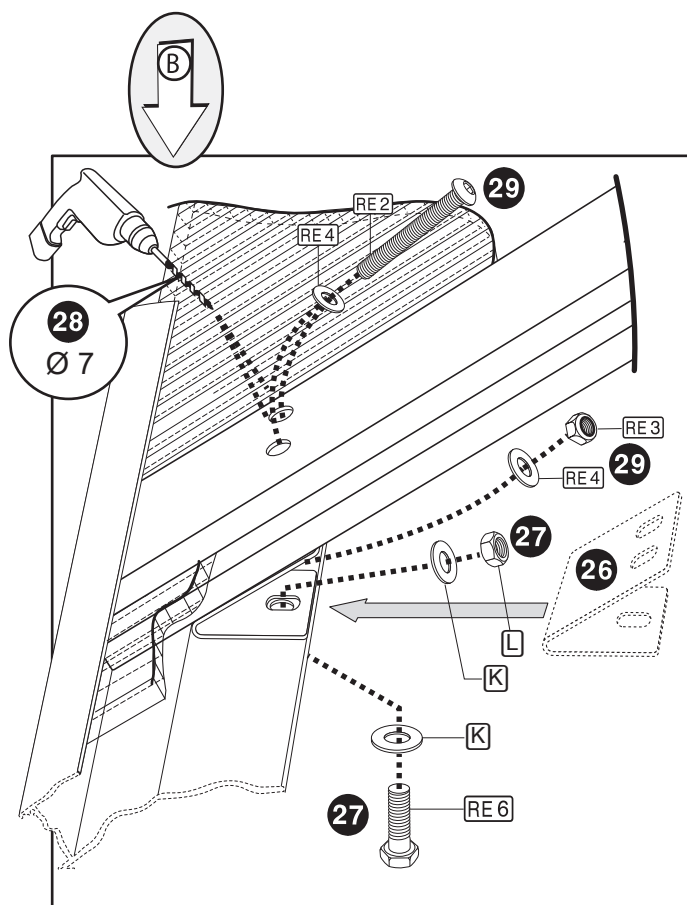
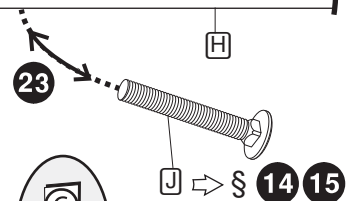
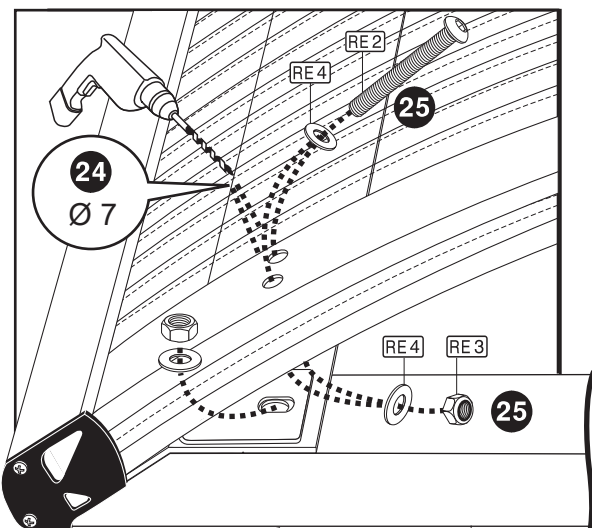
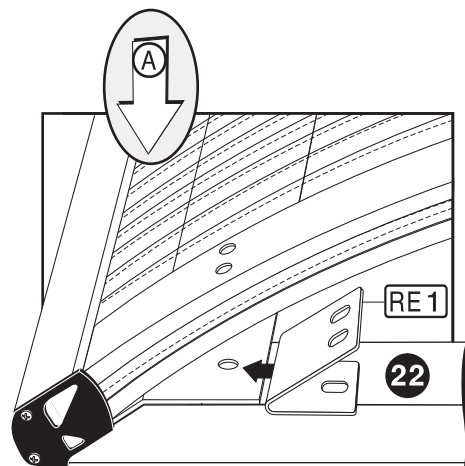
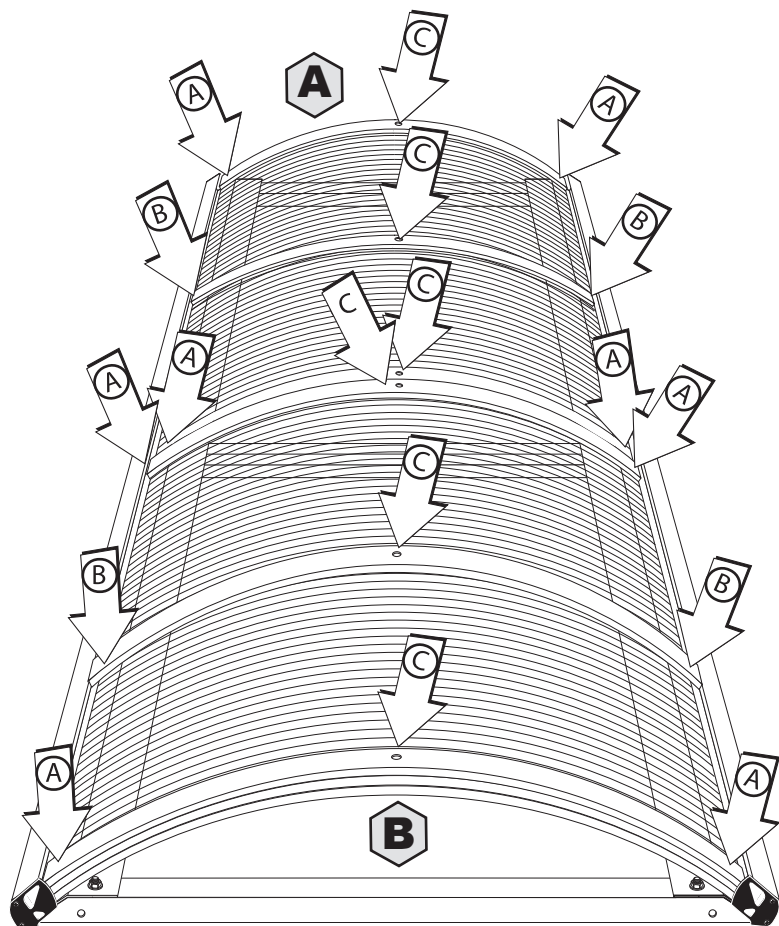

2 Side cladding panels in 2 sections for PARTS A & B - (for location see page 1/14)

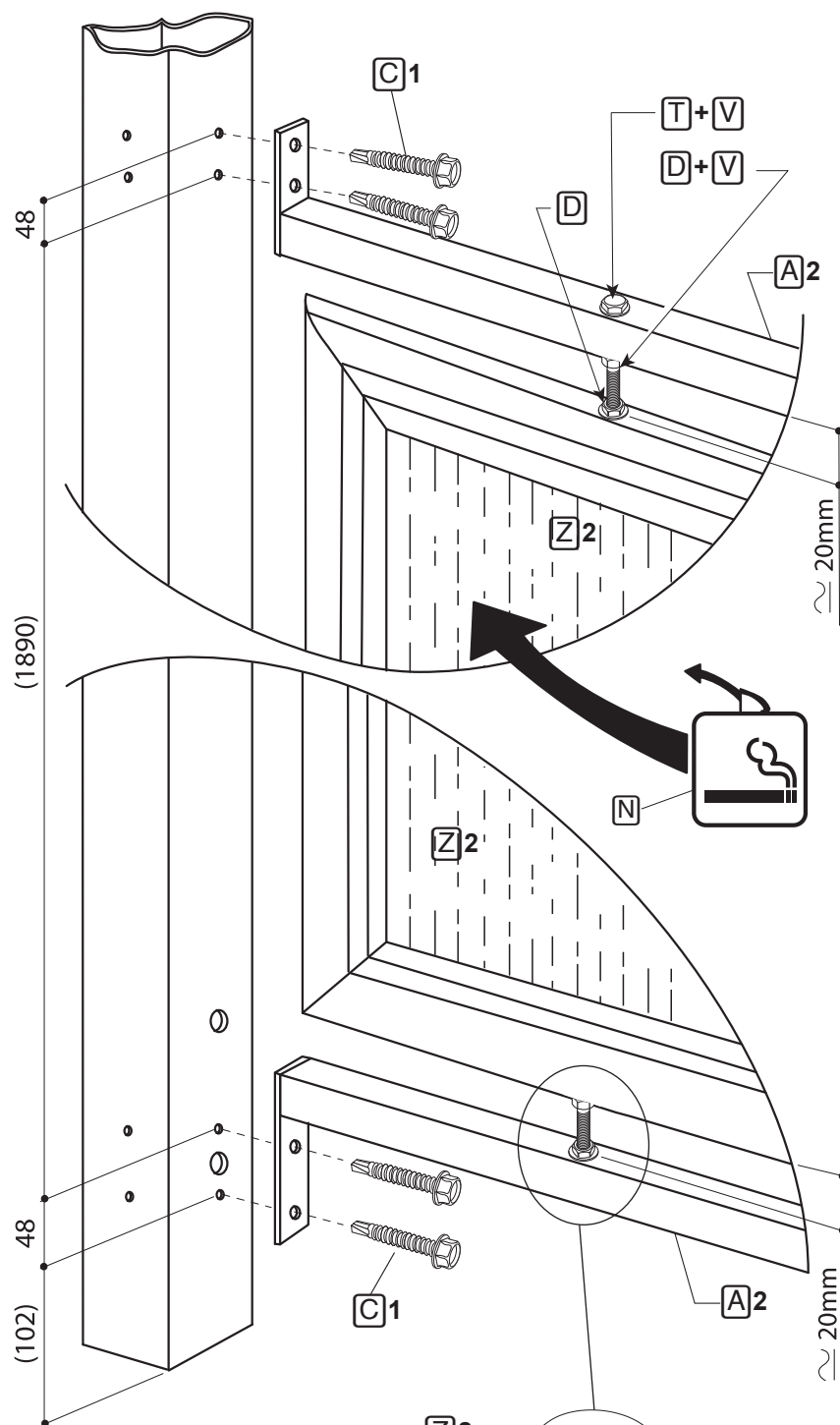
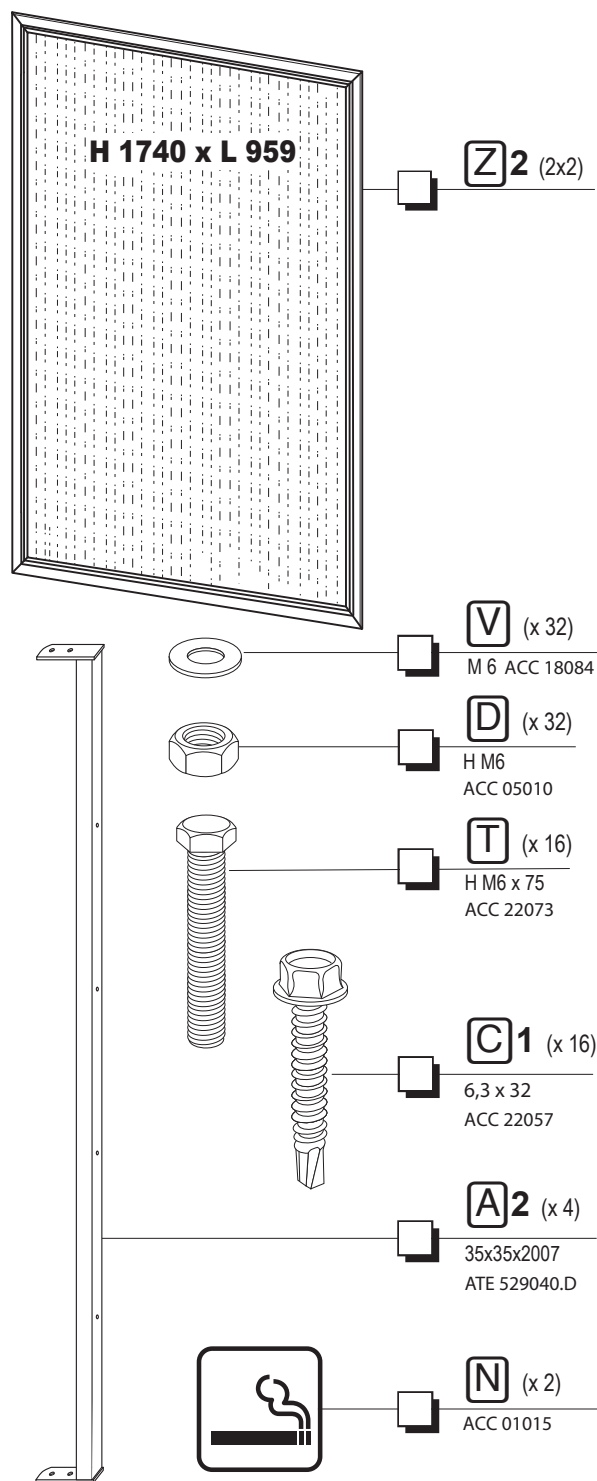

Installation Instructions:

Start by installing the cross-members **A2** on the shelter using screws **C1**.

Attach the claddings on the cross-members using screws **T**.

On the lower cross-member, leave 1 to 2mm play between the washer & the cross-member (please refer to drawing).

Tighten an M6 bolt **D** on the cladding **1**, then on the cross-member **A2** **2** until disappearance of the play.

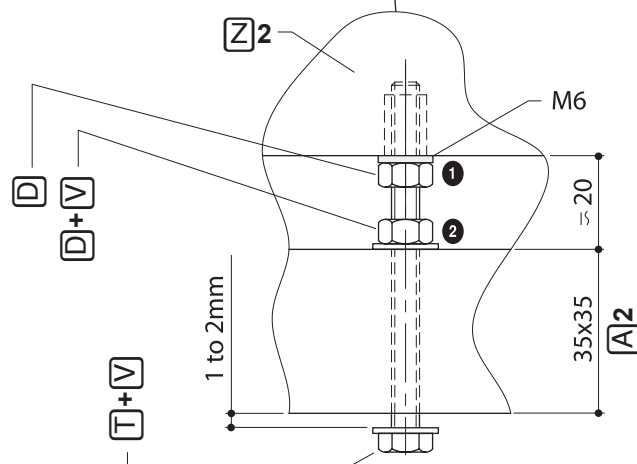

1 Rear cladding panel in 2 sections for PART A

(for location see page 1/14)

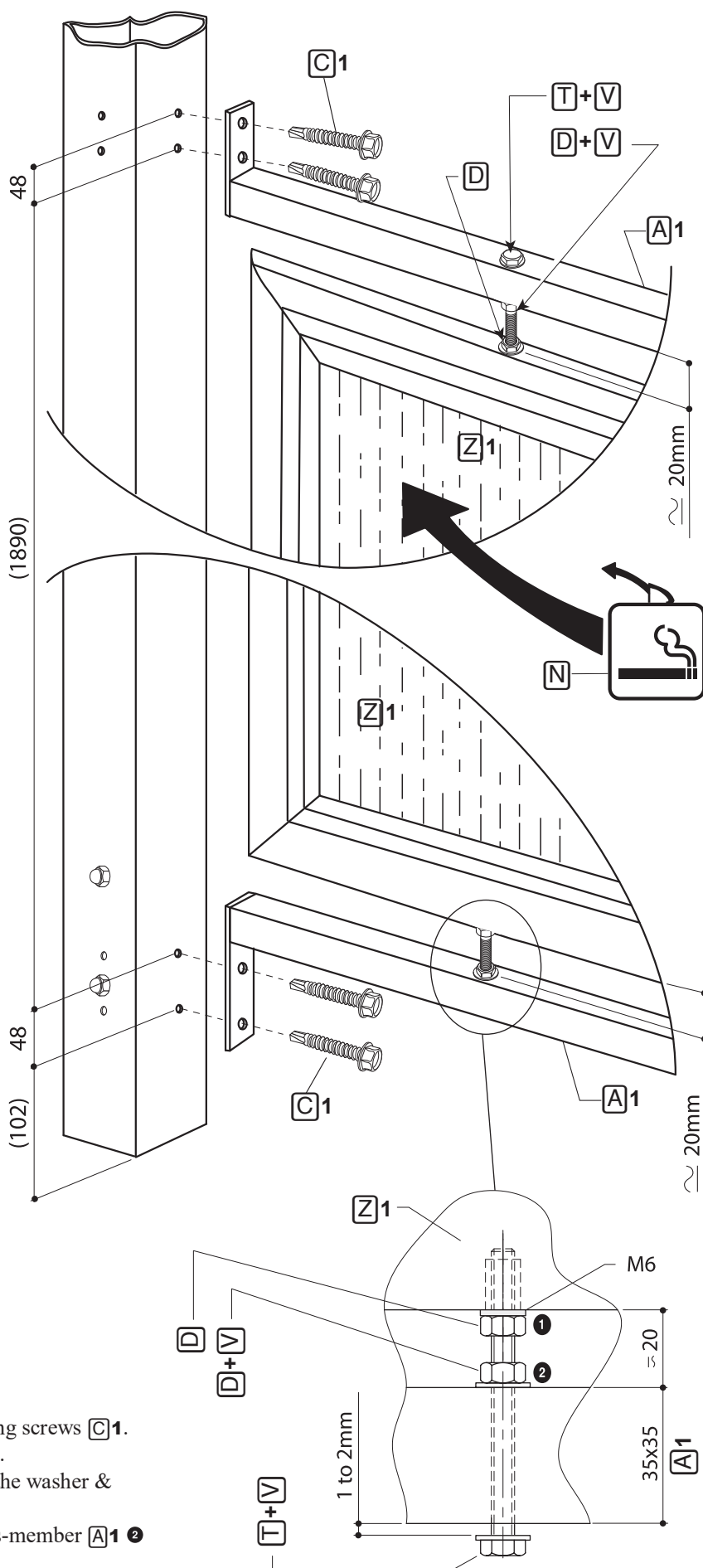
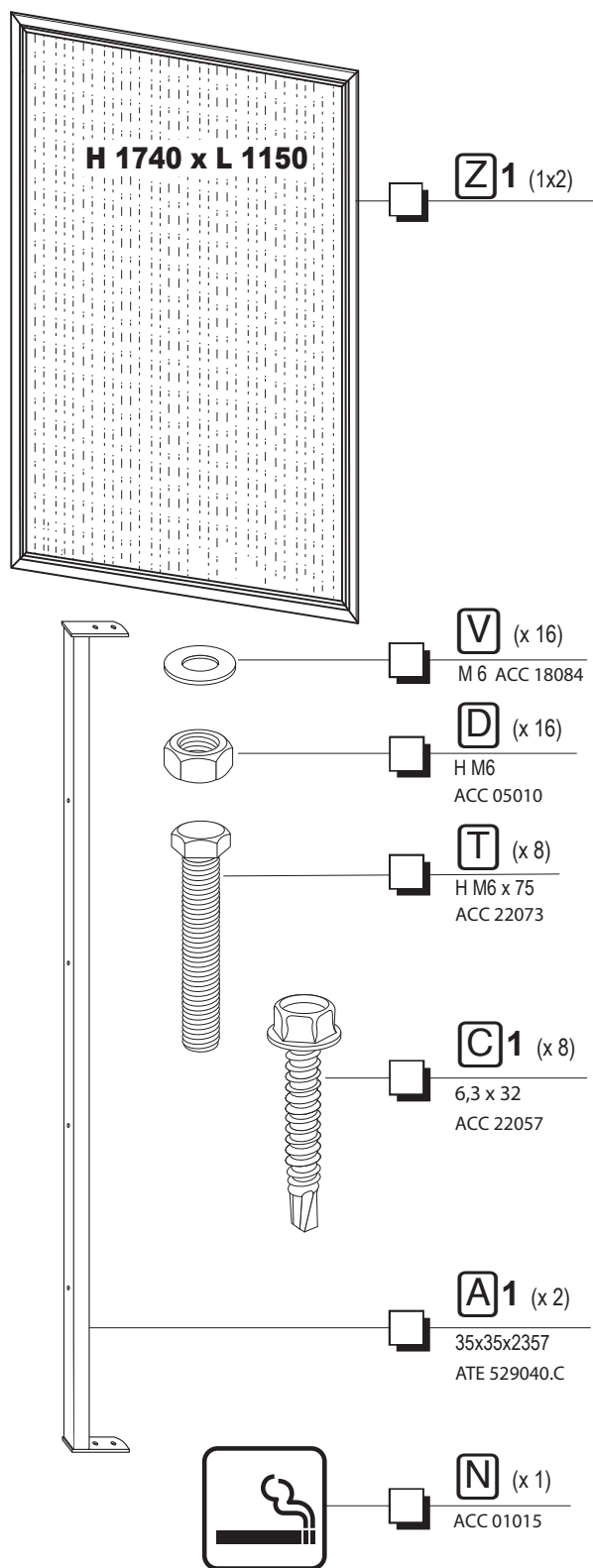

Installation Instructions:

Start by installing the cross-members **A1** on the shelter using screws **C1**.

Attach the claddings on the cross-members using screws **T**.

On the lower cross-member, leave 1 to 2mm play between the washer & the cross-member (please refer to drawing).

Tighten an M6 bolt **D** on the cladding **1**, then on the cross-member **A1** **2** until disappearance of the play.

1 Rear cladding panel in 2 sections for PART B (for location see pages 1/14)

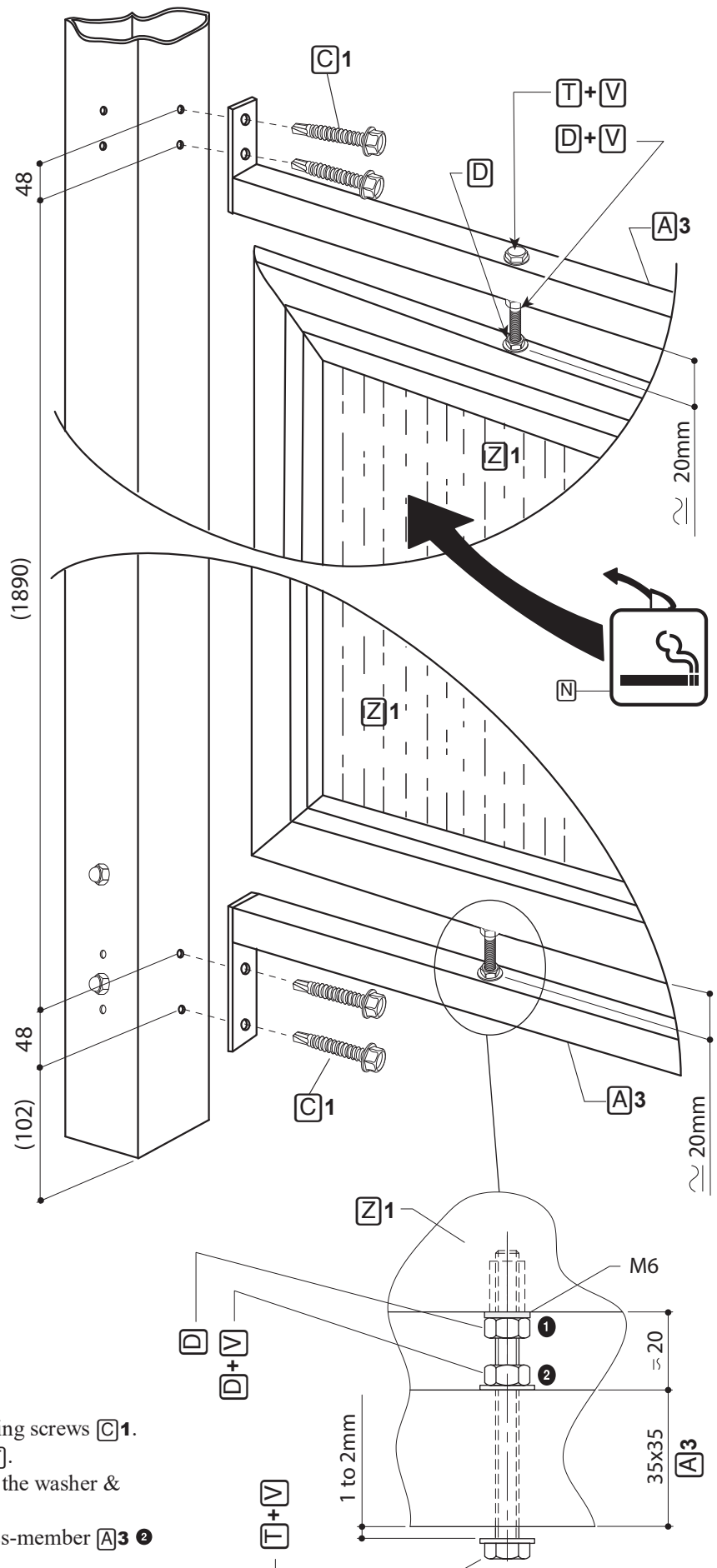
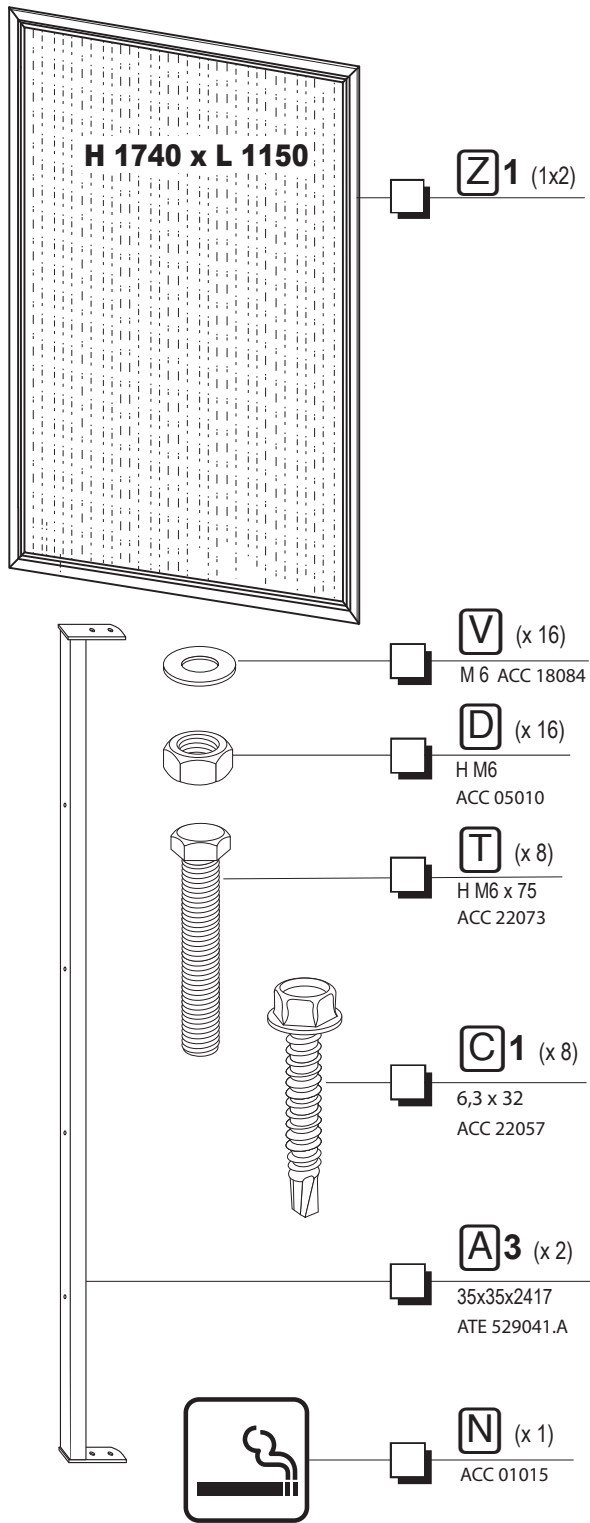

Installation Instructions:

Start by installing the cross-members **A3** on the shelter using screws **C1**.

Attach the claddings on the cross-members using screws **T**.

On the lower cross-member, leave 1 to 2mm play between the washer & the cross-member (please refer to drawing).

Tighten an M6 bolt **D** on the cladding **1**, then on the cross-member **A3** **2** until disappearance of the play.